

D darshana®

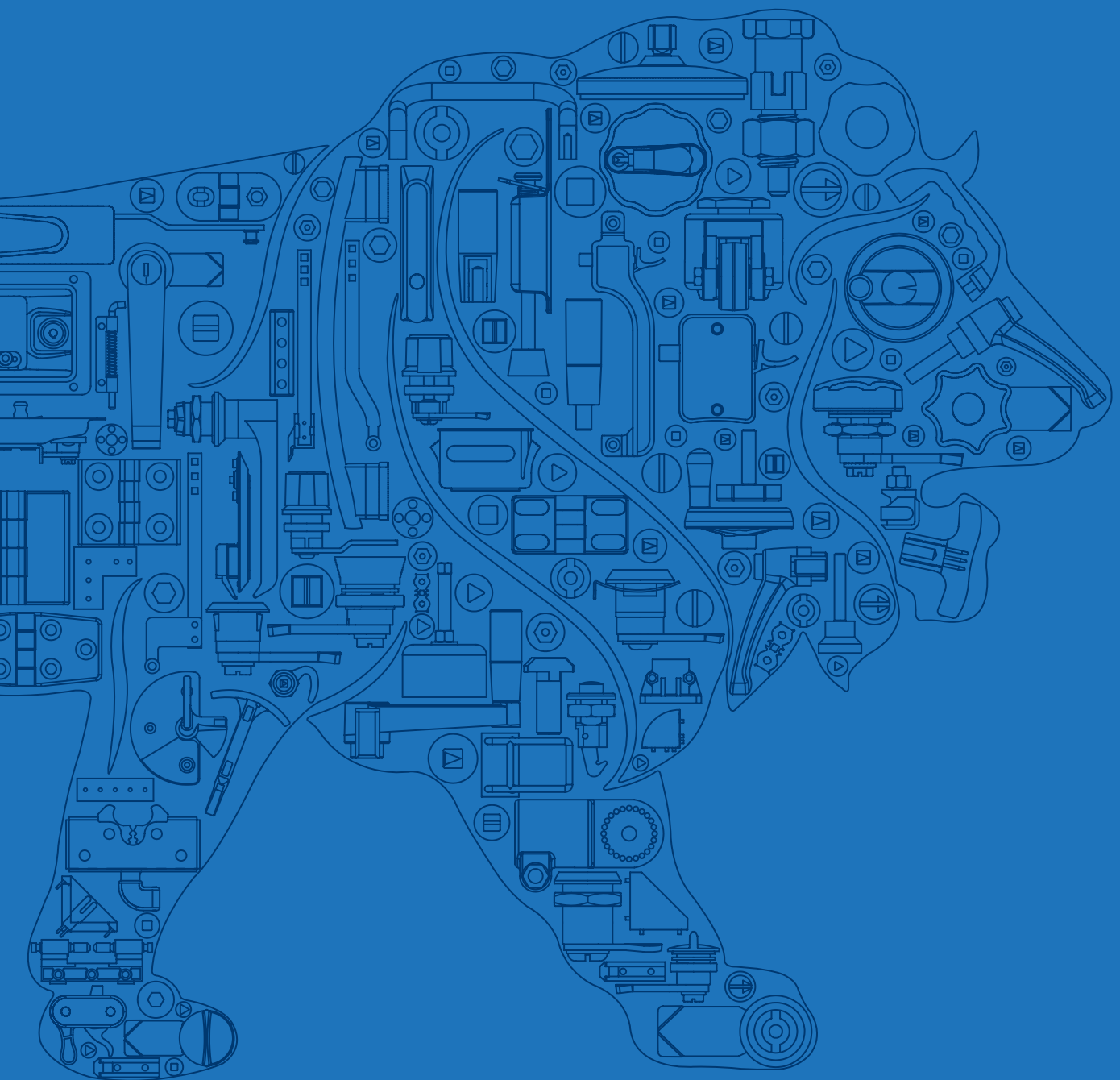

Made in India  Made for You

WHO WE ARE

India's Largest and Most Trusted Manufacturer of
Access Hardware and Machine Components

Founded in
1982

Highly focused on
INDIA'S
Strong Machine
Building Industry

Engineering

Tooling

Manufacturing

Sales

Two Locations in
PUNE

120,000 sq. ft.
(11,000 sq. m.)
AREA

OVER 350

People Committed to Customer Satisfaction

OVER 20 DEALERS

in India and reliable partners overseas to provide end to end
integration of parts in customer's designs

OVER 90%

of components used are

MADE-IN-HOUSE

Ensures control of quality and delivery

OUR PRESENCE IN VARIOUS SECTORS



Agriculture



Airline Industry



Automation



Automobile



Dairy



Defence



Earthmoving



Electric Panels



Food



Generator



Hospital Essentials



HVAC



Interior



Kitchen Equipment



Machine Building



Marine



Medical



Office Furniture



Pharma



Printing & Packing



Railways



Renewable Energy



Telecom



Waste Management

OUR GLOBAL PRESENCE

India

- Ahmedabad
- Aurangabad
- Bengaluru
- Chennai
- Coimbatore
- Delhi
- Goa
- Hyderabad
- Indore
- Kolhapur
- Mumbai
- Nagpur
- Nashik
- Noida
- Pune
- Punjab
- Rajkot
- Surat
- Vadodara

International

- Australia
- Canada
- Egypt
- France
- Iceland
- Ireland
- Israel
- Italy
- Kenya
- Kuwait
- Lebanon
- Malaysia
- Netherlands
- New Zealand
- Nigeria
- Oman
- Philippines
- Poland
- Saudi Arabia
- South Africa
- Spain
- Sri Lanka
- Thailand
- UAE
- United Kingdom
- Yemen
- Zambia
- USA

Vision

To be the leading trusted source of engineered machine components.

Mission

To create continuous growth opportunities through value driven product designs and operations.
We will achieve this growth through well engineered designs that ensure product reliability and efficient manufacturing operations that are committed to quality, consistency, and cost management
Customer connectivity that creates long-term relationships

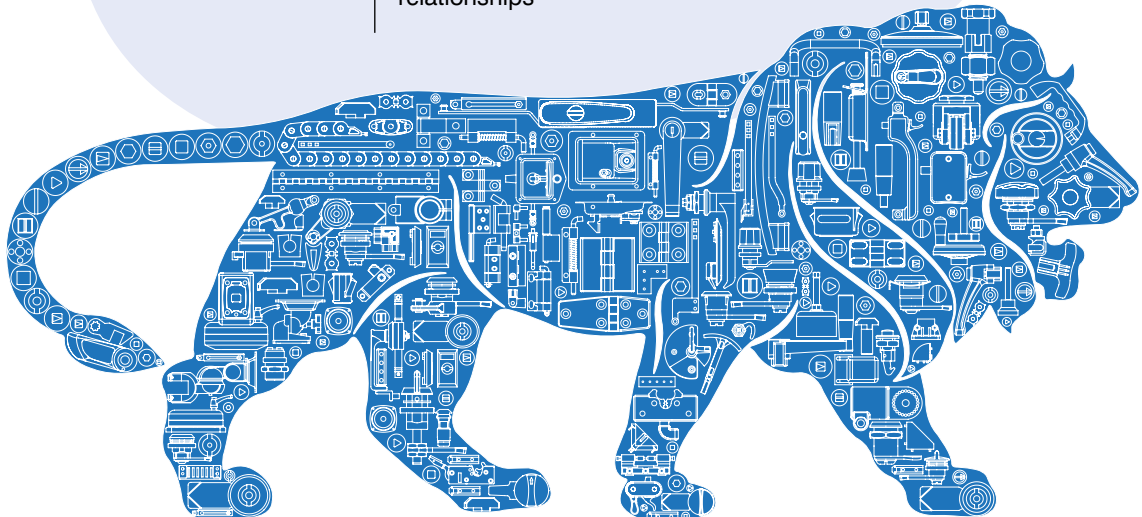

Made in India  Made for You



Primary Processes in Facility 1

- Zinc Die Casting
- Injection Molding
- Powder Coating
- Laser Cutting
- CNC Machining
- Gasketing
- Key Making
- Robotic Welding
- Robotic Buffing
- Automated Assembly Lines

ISO CERTIFIED

9001 : 15 | 14001 : 15 | 45001 : 15

Primary Processes in Facility 2

- Stamping Unit
- Riveting Line
- Secondary Finishing Lines
- Assembly
(Sheet Metal Components)
- Space for expansion

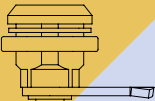
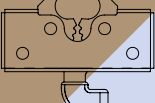
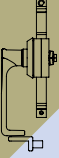
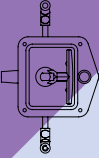
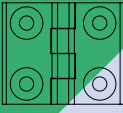
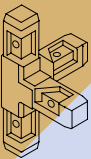

Product Categories

Colour coding for Category identification	Product Category	Category Sub Colour Shade	Page No.
 Category Number I	HANDLES		008 to 083
 Category Number II	LOCKS		084 to 119
 Category Number III	LATCHES		120 to 145
 Category Number IV	MULTI-POINT LOCKS		146 to 179
 Category Number V	CANOPY LOCKS		180 to 195
 Category Number VI	HINGES		196 to 267
 Category Number VII	CONVEYOR COMPONENTS		268 to 291

Part Code Configurator



For building the **Part Code** please fill the variables that are outlined values from the table referring the drawings.

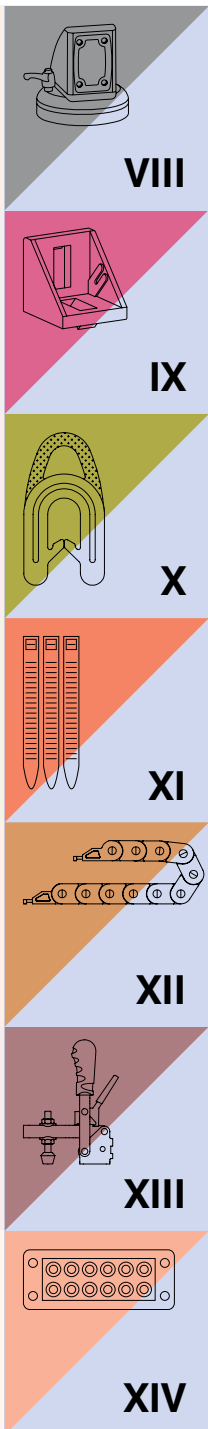

VIII

SUPPORT ARM SYSTEM

292 to 323

IX

ALUMINIUM SECTIONS & ACCESSORIES

324 to 343

X

GASKETS

344 to 349

XI

CONDUIT ACCESSORIES & CABLE TIES

350 to 355

XII

DRAG CHAINS

356 to 361

XIII

TOGGLE CLAMPS

362 to 379

XIV

CABLE MANAGEMENT SYSTEM

380 to 385

Part Code Index

Product Name	Material	Page
Vertical Hold Down Action	MS	364
		365
		366
		367
Horizontal Hold Down Action		368
		369
		370
		371
Straight Line Action		372
		373
		374
		375
	376	
	377	
Squeeze Action Clamps		378
Pull Action Clamps		
Vertical Hold Down Action		
Pull Action Clamps		379

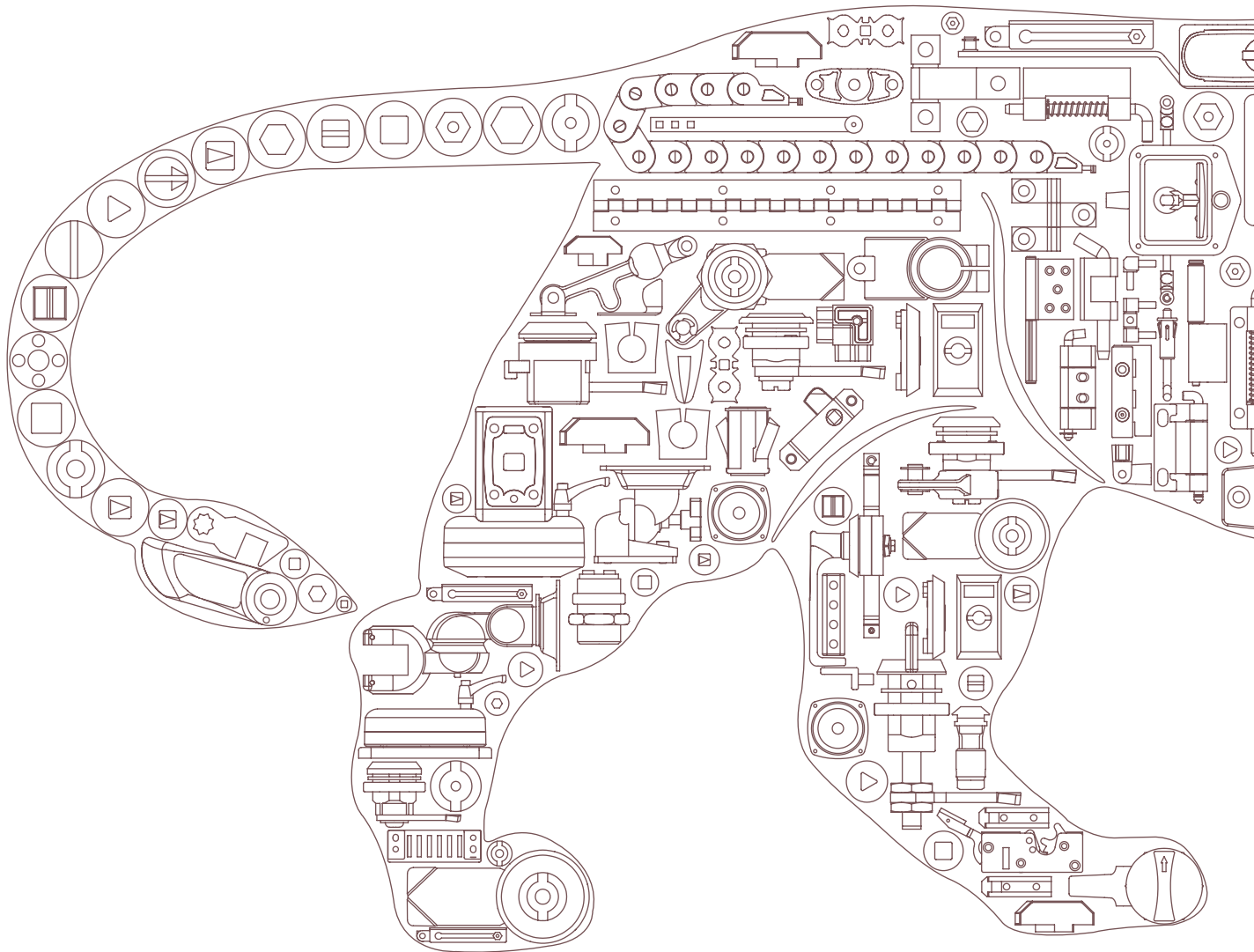

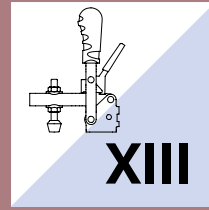

TOGGLE CLAMPS

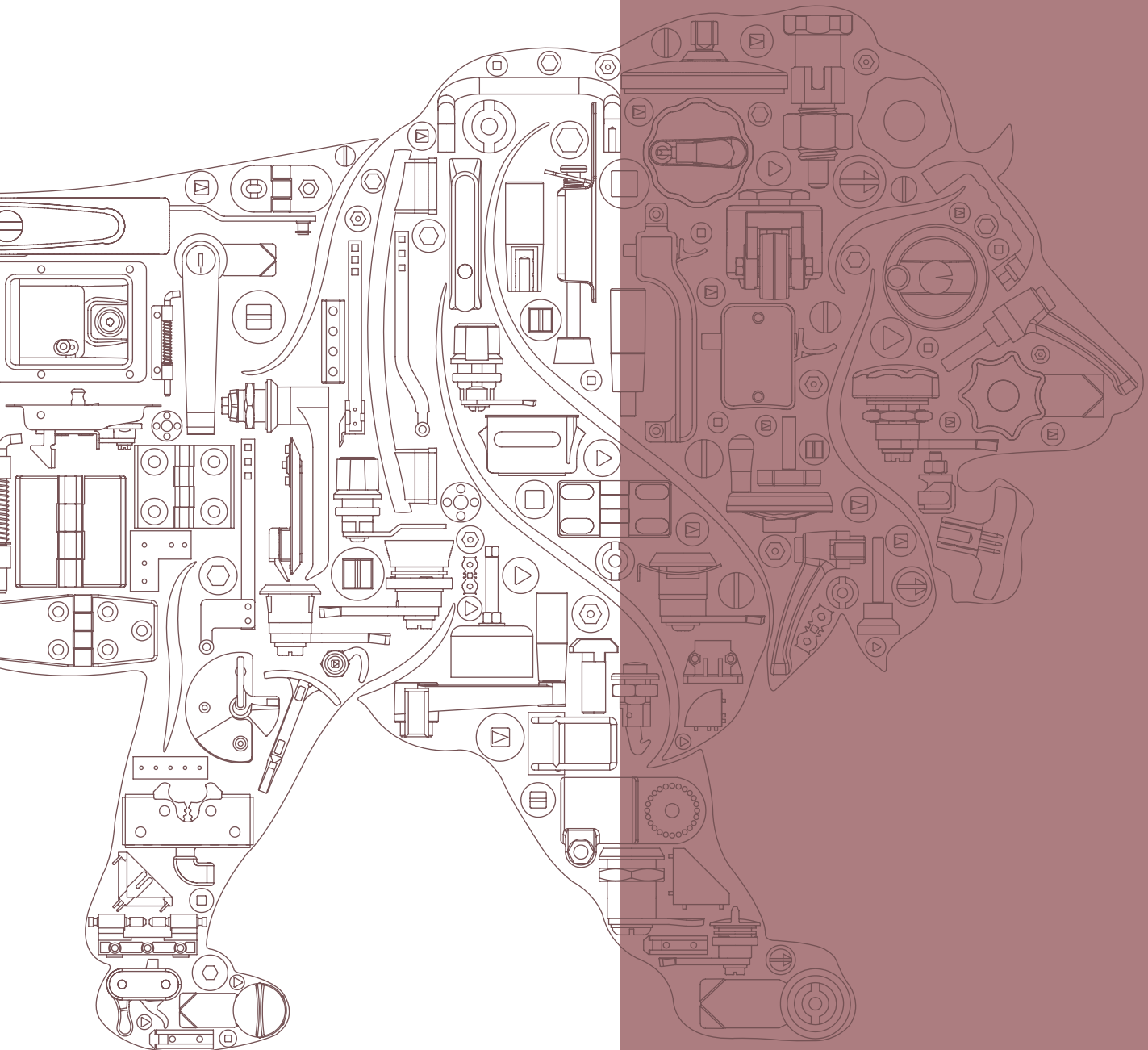

Made in India  Made for You

TOGGLE CLAMPS

Vertical Hold Down Action

MS

XIII



Part Code	a	a1	b	b1	c	d	e	f	g	h
DTC-V22-1110-CZ	86	64	50.5	55	16	16	23.9	25	33	25.5
DTC-V24-1110-CZ	119	94	71.3	74.5	24	12.7	26.9	25.5	39.3	45.8
DTC-V24-1210-CZ	119	108.5	86	74.5	24	12.7	26.9	25.5	39.3	60.5
DTC-V26-1110-CZ	177	126.5	92.6	115	31	19.1	31.8	35.1	44.6	57.5
DTC-V26-1210-CZ	177	137	104.1	115	31	19.1	31.8	35.1	44.6	69
DTC-V26-1310-CZ	177	168.5	139.1	115	31	19.1	31.8	35.1	44.6	104
DTC-V27-1110-CZ	199	181	139.6	114.5	42	31.8	45.2	48.6	64.4	91
DTC-V28-1110-CZ	231	212	174.8	149	50.8	31.8	45	50.8	60.6	124
DTC-V29-1140-CZ	316	310	233	174	82	50.8	69.9	76.2	95	156.8
DTC-V24-1510-CZ	119	82.5	58.8	74.5	24	12.7	26.9	25.5	39.3	33.3
DTC-V26-1111-CZ	177	126.5	92.6	115	31	19.1	31.8	35.1	44.5	57.5
DTC-V27-1111-CZ	199	181	139.6	114.5	42	31.8	45.2	48.6	64.4	91

Vertical Hold Down Action

MS

Additional Locking Mechanism is available in all Toggle clamp models other than Squeeze Action Clamps.

Clamps can be made in Stainless Steel on Minimum Order Quantities

Part Code	a	a1	b	b1	c	d	e	f	g	h
DTC-V26-1610-CZ	177	123	90.1	116	31	19.1	31.8	35.1	44.5	55
DTC-V27-1610-CZ	199	179	138.6	114	42	31.8	45.2	48.6	64.4	90

TOGGLE CLAMPS

Vertical Hold Down Action

MS

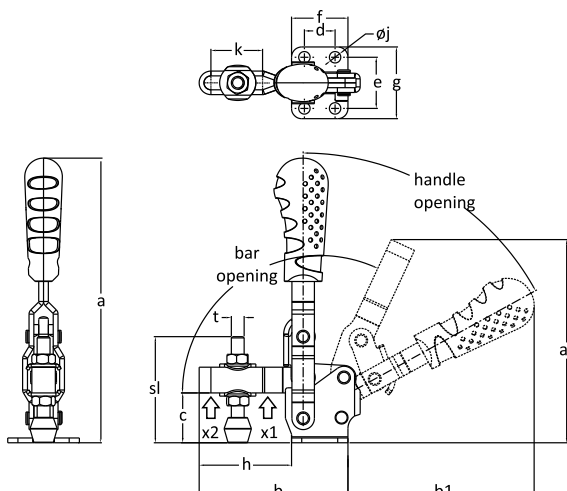

j	k	t	sl	Arm Type	Base Type	Holding Capacity(kN)		Handle Opening	Bar Opening
						X2	X1		
4.5	18.3	M5	33	Adjustable	Flanged	0.24	0.5	65°	114°
5.5	25.4	M6	46			0.62	1	64°	104°
5.5	40	M6	46			0.62	1	64°	104°
7.1	32	M8	66			1	1.7	63°	115°
7.1	44	M8	66			1	1.7	61°	115°
7.1	78.5	M8	66			0.7	1.7	63°	115°
8.3	60	M10	86			1.4	2.7	58°	106°
8.6	85	M12	116			2	4.4	67°	120°
12.5	98	M16	170			2	5.4	60°	110°
5.5	26.3	M6	46			Spindle Fixed		0.62	-
7.1	32	M8	66	Adjustable		1	1.7	63°	115°
8.3	60	M10	86			1.4	2.7	58°	106°

Vertical Hold Down Action

MS

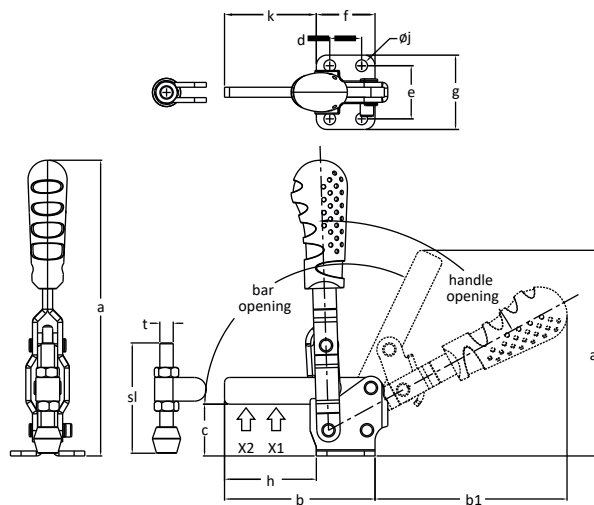

j	k	t	sl	Arm Type	Base Type	Holding Capacity(kN)		Handle Opening	Bar Opening
						X2	X1		
7.1	55	M8	66	Solid	Flanged	1.5	2.1	63°	115°
8.3	90	M10	86			2.2	3.4	58°	106°

XIII



I



II



III



IV



V



VI



VII



VIII



IX



X



XI



XII



XIII



XIV



TOGGLE CLAMPS

Vertical Hold Down Action

MS



Part Code	a	a1	b	b1	c	d	e	f	g	h
DTC-V22-2110-CZ	96.5	74.5	50.5	55	26.5	16	5	25	4	25.5
DTC-V24-2110-CZ	129	105.5	71.3	74.5	35.1	12.7	6.8	25.5	6	45.8
DTC-V26-2110-CZ	190	141.5	92.6	115	46.35	19.1	6.35	35.1	6	57.5
DTC-V26-2210-CZ	190	153	104.4	115	46.35	19.1	6.35	35.1	6	69.3
DTC-V26-2310-CZ	190	184	139.1	115	46.35	19.1	6.35	35.1	6	104
DTC-V27-2110-CZ	220.5	204	139.6	112	65.5	31.8	9	48.6	8	91
DTC-V28-2110-CZ	249.5	231	174.8	149	69.7	31.8	9.7	50.8	10	124



Part Code	a	a1	b	b1	c	d	e	f	g	h
DTC-V36-1110-CZ	203	124.5	105	98.5	65	25	55	45	85	60

XIII



I



II



III



IV



V



VI



VII



VIII



IX



X



XI



XII



XIII



XIV

Vertical Hold Down Action

MS

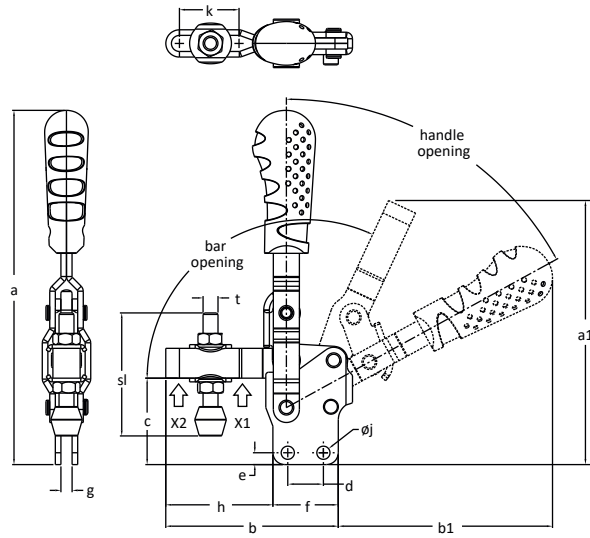

j	k	t	sl	Arm Type	Base Type	Holding Capacity(kN)		Handle Opening	Bar Opening
						X2	X1		
4.5	18.3	M5	33	Adjustable	Straight	0.24	0.5	65°	114°
5.5	25.4	M6	46			0.62	1	64°	104°
7.1	32	M8	66			1	1.7	63°	115°
7.1	44	M8	66			1	1.7	61°	115°
7.1	78.5	M8	66			0.7	1.7	63°	115°
8.3	60	M10	86			1.4	2.7	58°	106°
8.6	85	M12	116			2	4.4	67°	120°

Vertical Hold Down Action

MS

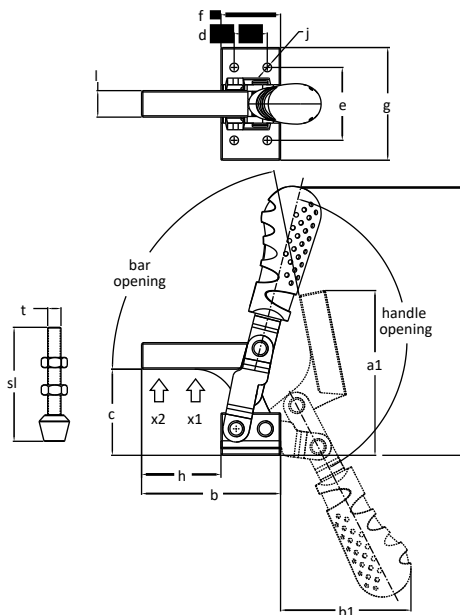

j	k	t	sl	Arm Type	Base Type	Holding Capacity(kN)		Handle WOpening	Bar Opening
						X2	X1		
6.5	20	M10	86	Solid	Flanged	3.4	4.9	135°	85°

XIII



I



II



III



IV



V



VI



VII



VIII



IX



X



XI



XII



XIII



XIV

TOGGLE CLAMPS

Horizontal Hold Down Action

MS



Part Code	a	a1	b	b1	c	d	d1	e	e1	f	g
DTC-H21-1120-CZ/SS	17.5	37	69	47	7.9	16	11.2	15.7	-	23.9	23.7
DTC-H22-1120-CZ	29	50	85.5	65.5	12	15.8	11.1	16		24	24
DTC-H22-1420-CZ	29	51	85.5	66	20.7	15.8	11.1	16		24	24
DTC-H24-1120-CZ/SS	39	87.5	148	96	27	25.4	27	22		35.6	35
DTC-H26-1120-CZ	47	101	178	114	34	25.4		22.4		38.1	35
DTC-H42-1110-CZ/SS	36	72	111	62	19.5	13.5		17.6	19	25.5	28
DTC-H44-1110-CZ/SS	52	111	174	99	27	26.2		23.7	29.5	37.6	41.1
DTC-H45-1110-CZ	37	75	157	112	24	24		34		42	56
DTC-H46-1110-CZ/SS	62	123	210	121	34	26.2		31.6	26.6	39.6	44
DTC-H27-1110-CZ	68	155	276	174	45	41.4		41.4		57.2	57.2
DTC-H47-1110-CZ	80	183	282	150	44	41.4		43	39	57.2	58
DTC-H48-1110-CZ	109	210	329	219	58	41.4		41.4	-	66.8	68.6



Part Code	a	a1	b	b1	c	d	e	f	g
DTC-V22-1160-CZ	65	65	50.5	36.5	16	16	23.9	25	33
DTC-V24-1260-CZ	80	108.5	86	39.5	23.9	12.7	26.9	25.5	39.3
DTC-V26-1360-CZ	114	168.5	139.1	62.5	31	19.1	31.8	35.1	44.6

TOGGLE CLAMPS

Horizontal Hold Down Action

MS

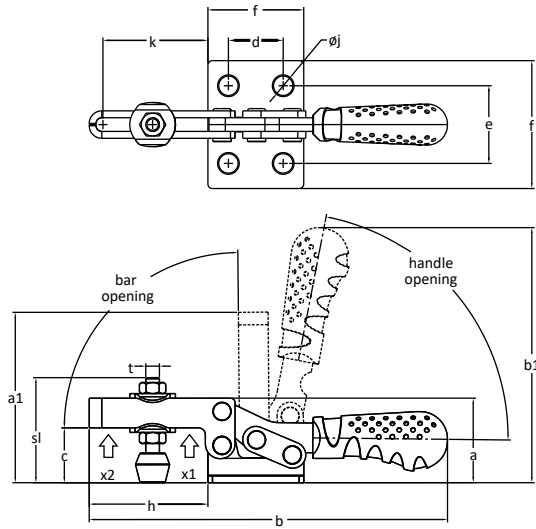

h	j	k	t	sl	Arm Type	Base Type	Holding Capacity(kN)		Handle Opening	Bar Opening
							X2	X1		
23	4.3	10	M4	24	Adjustable	Flanged	0.1	0.3	75°	85°
29	4.3	12	M5	33			0.2	0.5	90°	90°
29	4.3	12	M5	33			0.2	0.500	87°	85°
63	5x5.8	35	M6	55			0.5	1.000	78°	90°
73.5	6.8	33	M8	66			1.1	2.2	66°	90°
39.5	4.3x5	24	M5	33			0.3	0.700	60°	90°
63	5.5x8.4	42	M6	55			0.36	1.000	65°	92°
52	8.5	46	M6	46			1	2.4	80°	90°
72	6.8x9.3	41	M8	66			1	2.200	60°	92°
113	8.5	70	M10	86			1.3	3.4	85°	71°
106.5	8.5x10.5	80	M10	86			1.3	3.400	60°	92°
128	8.7	80	M12	116			1.8	4.400	70°	100°

Horizontal Hold Down Action

MS

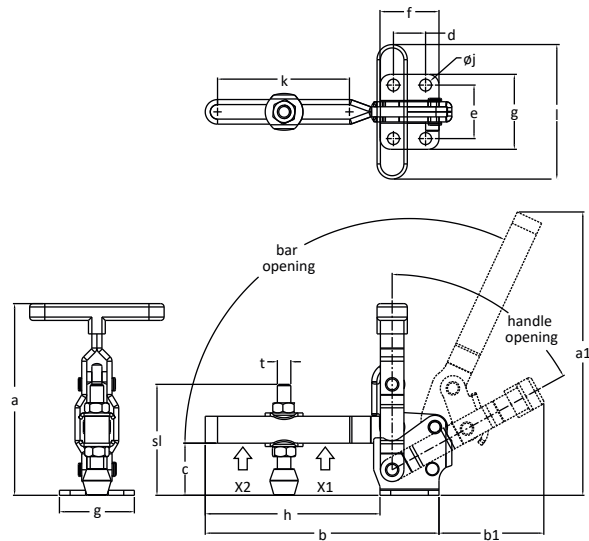

h	j	k	m	t	sl	Arm Type	Base Type	Holding Capacity(kN)		HandleOpening	Bar Opening
								X2	X1		
25.5	4.5	18.3	48	M5	33	Adjustable	Flanged	0.24	0.5	63°	110°
60.5	5.5	40	66	M6	46			0.62	1	63°	104°
104	7.1	78.5	80	M10	66			0.7	1.500	63°	115°

XIII



I



II



III



IV



V



VI



VII



VIII



IX



X



XI



XII



XIII



XIV

TOGGLE CLAMPS

Horizontal Hold Down Action

MS



Part Code	a	a1	b	b1	c	d	e	f	g	h
DTC-H32-1130-CZ / SS	38	56.5	56.1	33	12.5	13.5	16	26.1	25.4	30
DTC-H36-1130-CZ / SS	66	92	88.6	52	23.5	23	29.4	43.6	46.6	45
DTC-H37-1130-CZ	91.2	129	131.6	72.5	33.3	35.1	38.1	64	62.7	67.6



Part Code	a	a1	b	b1	c	d	e	f	g	h
DTC-H26-3110-CZ	63	101	162	135	50	20	25	32	38	46
DTC-H27-3110-CZ	79	157	240	170	60	25	30	42	46	90

XIII



I



II



III



IV



V



VI



VII



VIII



IX



X



XI



XII



XIII



XIV

TOGGLE CLAMPS

Horizontal Hold Down Action

MS

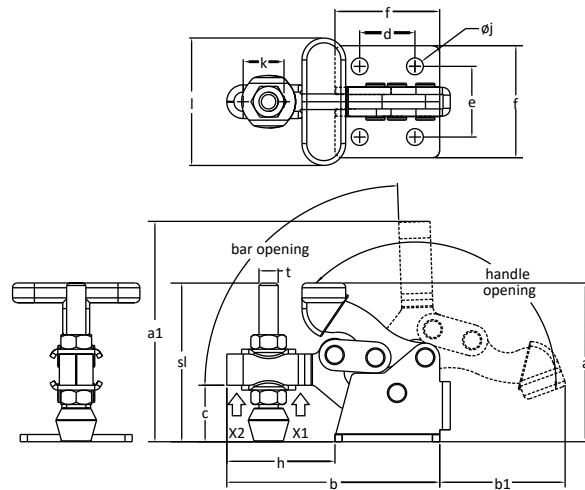

j	k	t	sl	Arm Type	Base Type	Holding Capacity(kN)		Handle Opening	Bar Opening
						X2	X1		
4.5	11.5	M5	33	Adjustable	Flanged	0.2	0.5	166°	92°
7	17	M8	66			1.1	1.4	175°	88°
8.4	26.9	M10	86			2.3	3.4	160°	90°

Horizontal Hold Down Action

MS

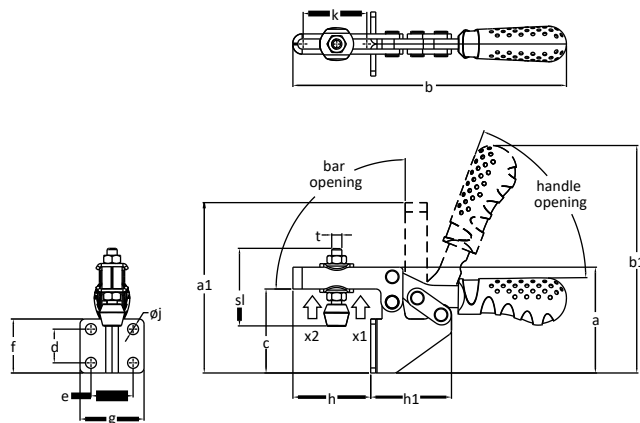

h1	j	k	t	sl	Arm Type	Base Type	Holding Capacity(kN)		Handle Opening	Bar Opening
							X2	X1		
48	5.5	38	M6	46	Adjustable	Front	1	2.4	70°	90°
63	7	80	M8	66			1.1	2.7	61°	87°

XIII



I



II



III



IV



V



VI



VII



VIII



IX



X



XI



XII



XIII



XIV



TOGGLE CLAMPS

XIII



I



II



III



IV



V



VI



VII



VIII



IX



X



XI



XII



XIII



XIV

Part Code	a	b	b1	c	d	e	f	g	h	h1
DTC-S41-1840-CZ/SS	31	67	37.5	12.5	16	16	34.5	27	32.5	23.5

Straight Line Action

MS



Part Code	a	b	b1	c	d	e	f	g	h	j
DTC-S42-1810-CZ	72	105	65	18	28	28	40	40	45	5.5
DTC-S48-1810-CZ	154.5	233	171.5	45	50	50	75	75	115	10.5
DTC-S46-1810-CZ	87	122	102	24.5	36.5	33	52	48	52	6.5
DTC-S47-1810-CZ	106	155	147	32	41.4	41.4	57	57	78	8.5
DTC-S44-1810-CZ		139	74.5	26	35	91.5	91.5	56	47.5	6.7
DTC-S43-1810-CZ	100	125	127	20	40	34	83	50	42	6.5

TOGGLE CLAMPS

Straight Line Action

MS

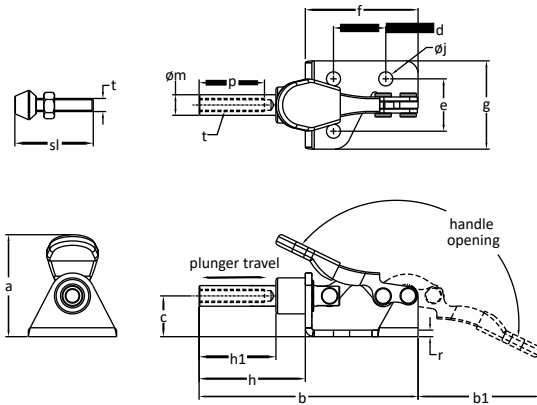

j	m	p	r	t	sl	Base Type	Plunger Travel	Handle Opening
4.3	6.3	20	2	M4 x 0.7	23	Flanged	16	180°

Straight Line Action

MS

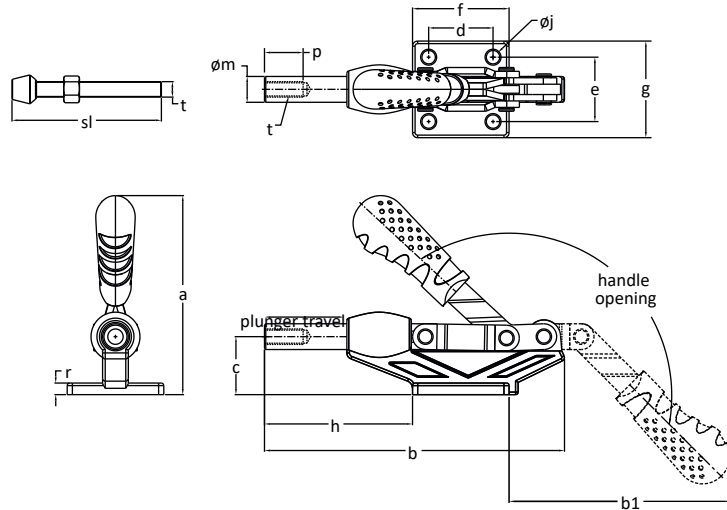

m	p	r	t	sl	Base Type	Plunger Travel	Holding Capacity (X) kN	Handle Opening
9	20	5	M5x0.8	33	Flanged	25	1	184°
20	30	9	M12x1.75	116	Flanged	60	6.9	182°
11	30	5	M8x1.25	66	Flanged	32	2.9	180°
15.8	32	6	M10x1.5	86	Flanged	41	3.9	178°
11	35	3	M8 x 1.25	66	Flanged	32	1.5	163°
12	30	3	M8 x 1.25	66	Flanged	30	1.33	163°

XIII



TOGGLE CLAMPS

- XIII
- I
- II
- III
- IV
- V
- VI
- VII
- VIII
- IX
- X
- XI
- XII
- XIII
- XIV

Part Code	a	b	b1	c	d	e	f	g	h	h1	j
DTC-S45-1810-CZ	79.5	140	88	25	35	41.4	90	56	50	-	5.6

Straight Line Action

MS



Part Code	a	a1	b	b1	c	d	e	f	g
DTC-S14-1810-CZ	61	88	158		23	16	42	28	54
DTC-S16-1810-CZ	64	128	230		30	30	55	50	75
DTC-S17-1810-CZ	64	137	248		30	30	55	50	75
DTC-S18-1810-CZ	85	156	299		35	45	60	68	78
DTC-S19-1840-CZ	122	176	384		50	50	75	75	100
DTC-S18-1811-CZ	85		299	156	35.5	45	60	68	78
DTC-S16-1811-CZ	77		230	128	30	30	55	50	75
DTC-S19-1841-CZ	122		384	176	50	50	75	75	100

TOGGLE CLAMPS

Straight Line Action

MS

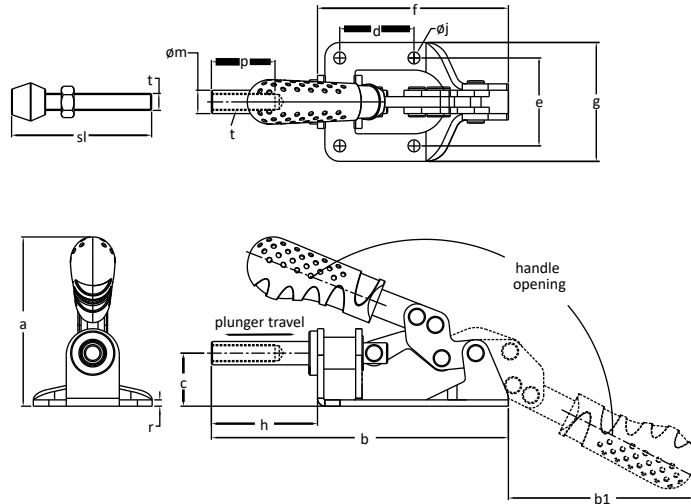

m	p	r	t	sl	Base Type	Plunger Travel	Holding Capacity (X) kN	Handle Opening
11	30	3	M8 x 1.25	66	Flanged	32.00 mm	1.33	185°

Straight Line Action

MS

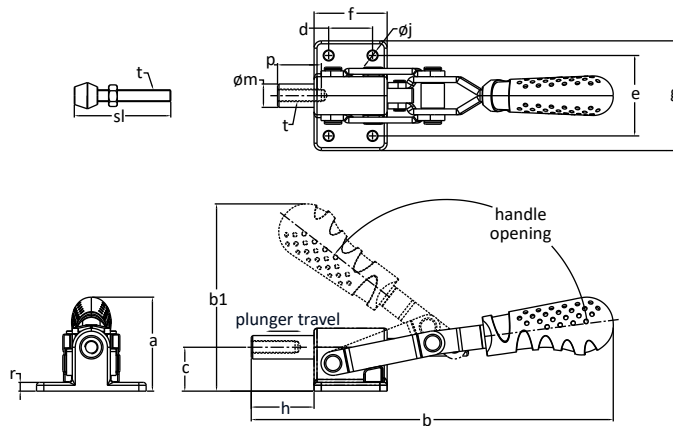

h	j	m	p	r	t	sl	Base Type	Plunger Travel	Holding Capacity (X) kN	Handle Opening
24	5.5	9.5	25	5.5	M6x1	46	Flanged	24	2.9	128°
25	6.5	12	30	6	M8x1.25	66	Flanged	25	10.8	135°
44	6.5	16	30	6	M10x1.5	86	Flanged	35	15	135°
46	8.5	20	30	9	M12x1.75	116	Flanged	46	25.5	130°
85	10.5	25	40	10	M16x2.0	173	Flanged	70	44.1	131°
46	8.5	20	30	9	M12	116	Flanged	46	25.5	130°
25	6.5	12	25	6	M8	65	Flanged	25	10.8	130°
85	10.5	25	40	10	M16	173	Flanged	70	44.1	131°

XIII



I



II



III



IV



V



VI



VII



VIII



IX



X



XI



XII



XIII



XIV



TOGGLE CLAMPS

- XIII
- I
- II
- III
- IV
- V
- VI
- VII
- VIII
- IX
- X
- XI
- XII
- XIII
- XIV

Part Code	a	b	c	d	e	f	g	h	j	k	k1
DTC-S32-1810L/R-CZ	25	111	15	66	36	82	53	29	5.2	66.5	66.5

Straight Line Action

MS



Part Code	a	b	b1	c	d	e	f	g	h	j	m
DTC-S23-1810-CZ	46	73	56	12.5	44.5	22.5	57	32	16	5.3	9.5
DTC-S22-1810-CZ	56	110	83	15	66	36	81	51	29	5.5	9
DTC-S28-1840-CZ	133	326	189	35	95	66	215	90	111	10.5	25
DTC-S29-1840-CZ	141	464	216	45	75	50	250	80	155	10.5	25
DTC-S46-1811-CZ	90	122	114	24.5	36.5	33	52	48	52	6.7	11
DTC-S47-1811-CZ	109	154	127	32	41.4	41.4	57	57	78	8.5	15.8
DTC-S48-1811-CZ	152	233	121	45	50	50	75	75	115	10.5	20

TOGGLE CLAMPS

Straight Line Action

MS

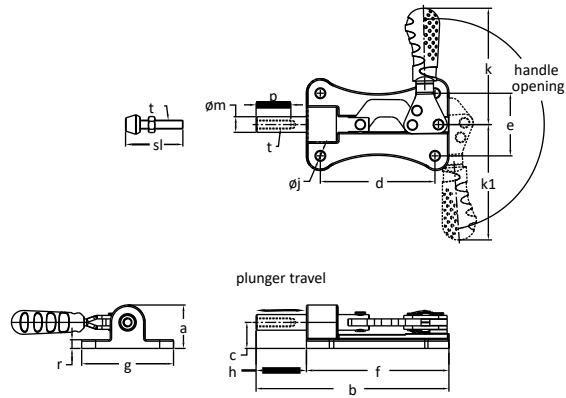

m	p	r	t	sl	Base Type	Plunger Travel	Holding Capacity (X) kN	Handle Opening
9	20	5	M5 x 0.8	33	Flanged	29.00 mm	1	177°

Straight Line Action

MS

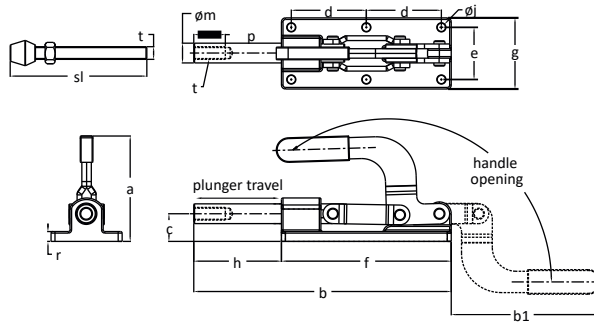

p	r	t	sl	Base Type	Plunger Travel	Holding Capacity (X) kN	Handle Opening
25	5	M6 x 1.0	46	Flanged	16	1.3	183°
20	5	M5 x 0.8	33		29	2	174°
40	12.5	M16x2.00	33		29	2	174°
40	12	M16x2.00	173		150	40	181°
30	5	M8	66		32	2.9	180°
32	6	M10	86		41	3.9	175°
30	9	M12	116		60	6.9	182°

XIII



I



II



III



IV



V



VI



VII



VIII



IX



X



XI



XII



XIII



XIV

TOGGLE CLAMPS

Squeeze Action Clamps

MS

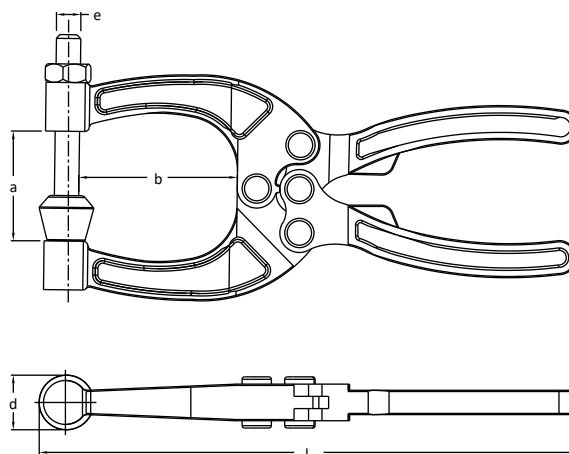

Part Code	a	b	DØ	e	l	Holding Capacity (X) kN
DTC-G74-0600-CB	24.5	28	13	M6X1.0	114.5	1
DTC-G76-0600-CB	35.5	56	16	M8X1.25	194	2
DTC-G77-0600-CB	45	70	18	M10X1.50	219	3.9

Pull Action Clamps

MS



Part Code	a	b	c	d	e	f	g	h	j	k
DDR-H31-1210-CZ/SS	33	84.5	10	16	19	26	28	20.3	4.2	19.1
DDR-H32-1210-CZ/SS	47	128.5	14.2	19.1	31.8	35.1	45	25	6.7	28
DDR-H36-1210-CZ/SS	78	177	19	41.5	38	60.5	54	38	8.5	44.5
DDR-H38-4240-CZ	92.5	213	35	57	57	85	80	55	10.5	48
DDR-H39-4200-CB	90	193	35	57	57	85	80	55	10.5	55
DDR-H21-1240-CZ	20	74	8		18	28	30	27	4.5	26
DDR-H31-1211-CZ/SS	32	84.5	10	16	19	26	28	20.3	4.2	19.1
DDR-H32-1211-CZ/SS	50	128.5	14.2	19.1	31.8	57	45	38	6.7	28
DDR-H36-1211-CZ/SS	80	179	19.1	41.4	38.1	83.5	54.1	38	8.5	44.5
DDR-H34-1211-CZ	54	150	18	25	28	62	45	33.5	6.5	47
DDR-H38-4241-CZ	92.5	213	35	57	57	85	80	55	10.5	48



I



II



III



IV



V



VI



VII



VIII



IX



X



XI



XII



XIII



XIV



Pull Action Clamps

MS

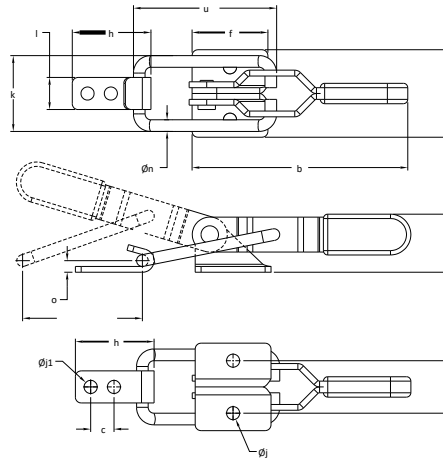

	I									
	13.2	4	12	14	25	57	M4	25	Flanged	1.5
	19	5	13.5	19	40	85	M5	45	Flanged	2.5
	31.2	8	23.7	21	42	115	M8	52	Flanged	8.8
	80	11		30	71	165	M12	85	Flanged	17.6
	80	11		30	71	165	M12	85	Flanged	34.3
	11	4	4			50			Flanged	0.5
	13.2	4	12	14	25	57	M4	25	Flanged	1.5
	19	5	13.5	19	40	85	M5	45	Flanged	3.2
	31	8	24	22	42	115	M8	52	Flanged	8.8
	23	6	16	45	79	130	M6	55	Flanged	3.4
	80	11		30	17	165	M12	85	Flanged	17.6

Ideas



Darshana Industries Pvt. Ltd.

📍 Head Office & Factory:
Sub Plot No. 32, Final Plot No. 6,
Ramtekdi Industrial Estate, Hadapsar,
Pune-411 028. Maharashtra, INDIA.

☎ Tel: +91 20 2951 1572

🌐 darshanaindustries.com

Head of Sales & Exports

👤 **Sanket Sutrave**
✉ ssutrave@darshanaindustries.com

Head of Business Development

👤 **Jethan Reddy**
✉ jmadhireddy@darshanaindustries.com

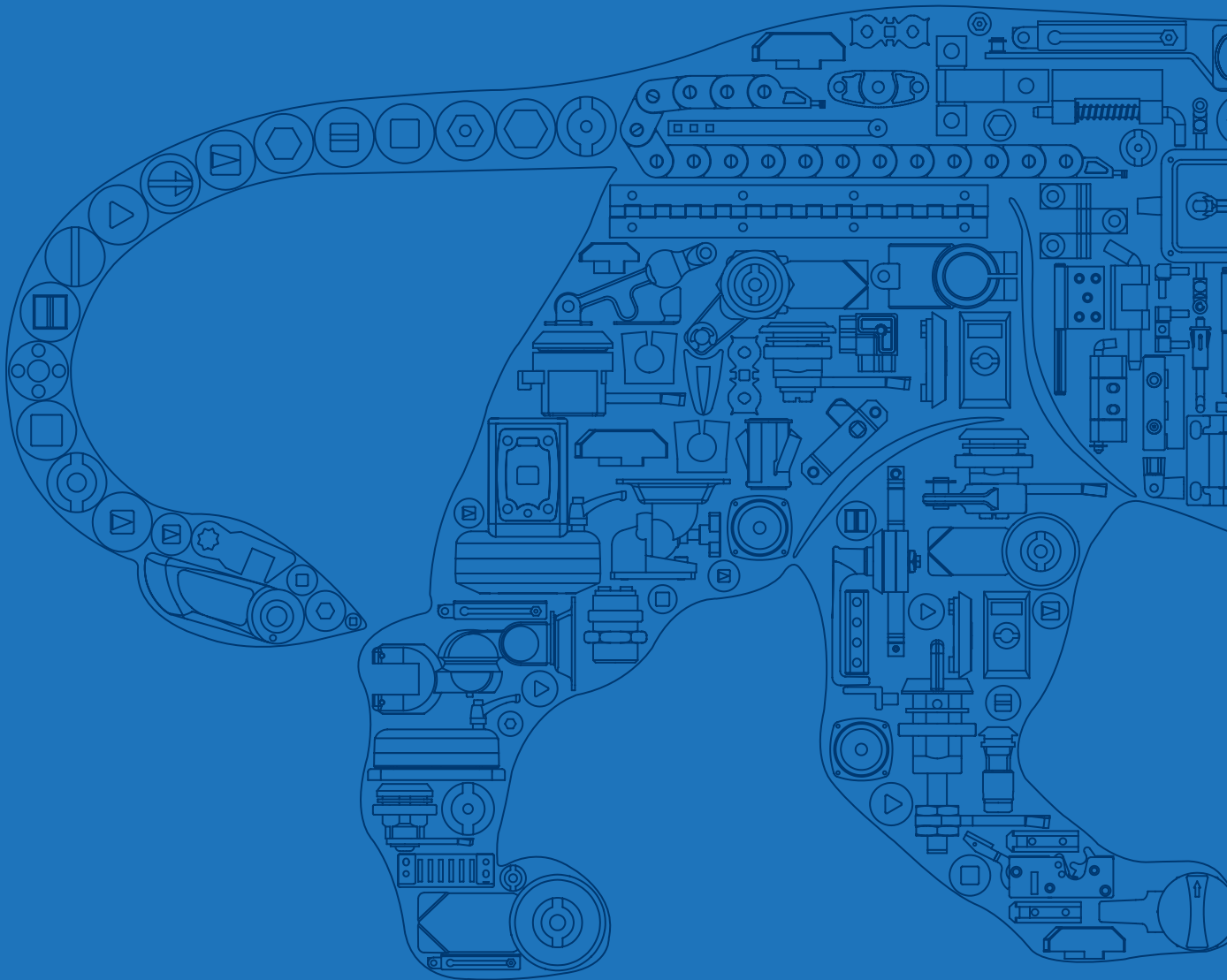

Made in India 🌐 Made for You